

LEGENDA

- 01 Montante M36
- 02 Basetta semplice in plastica
- 06 Piano a gancio
- 07 Gancio per piano (sx)
- 08 Fascia laterale

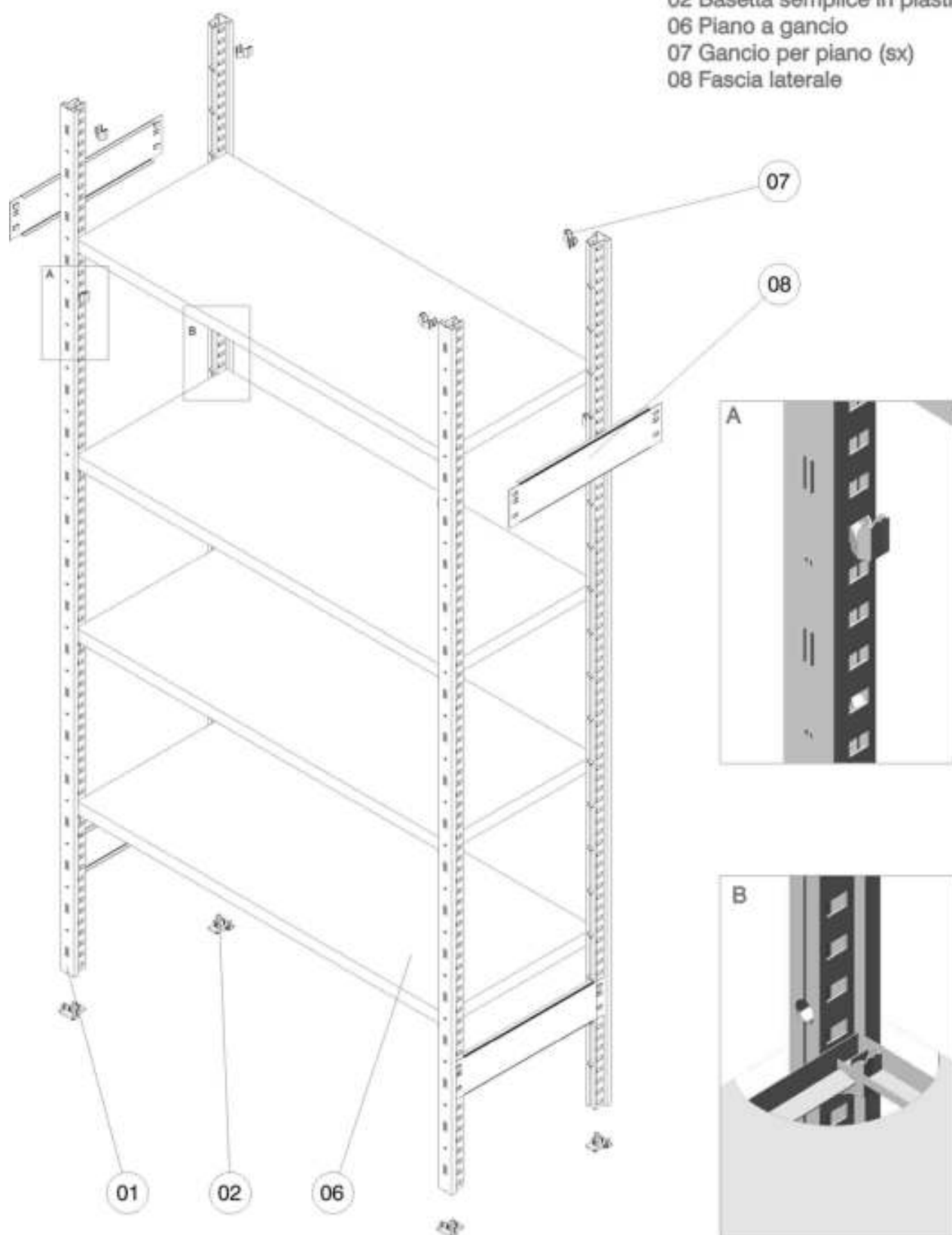

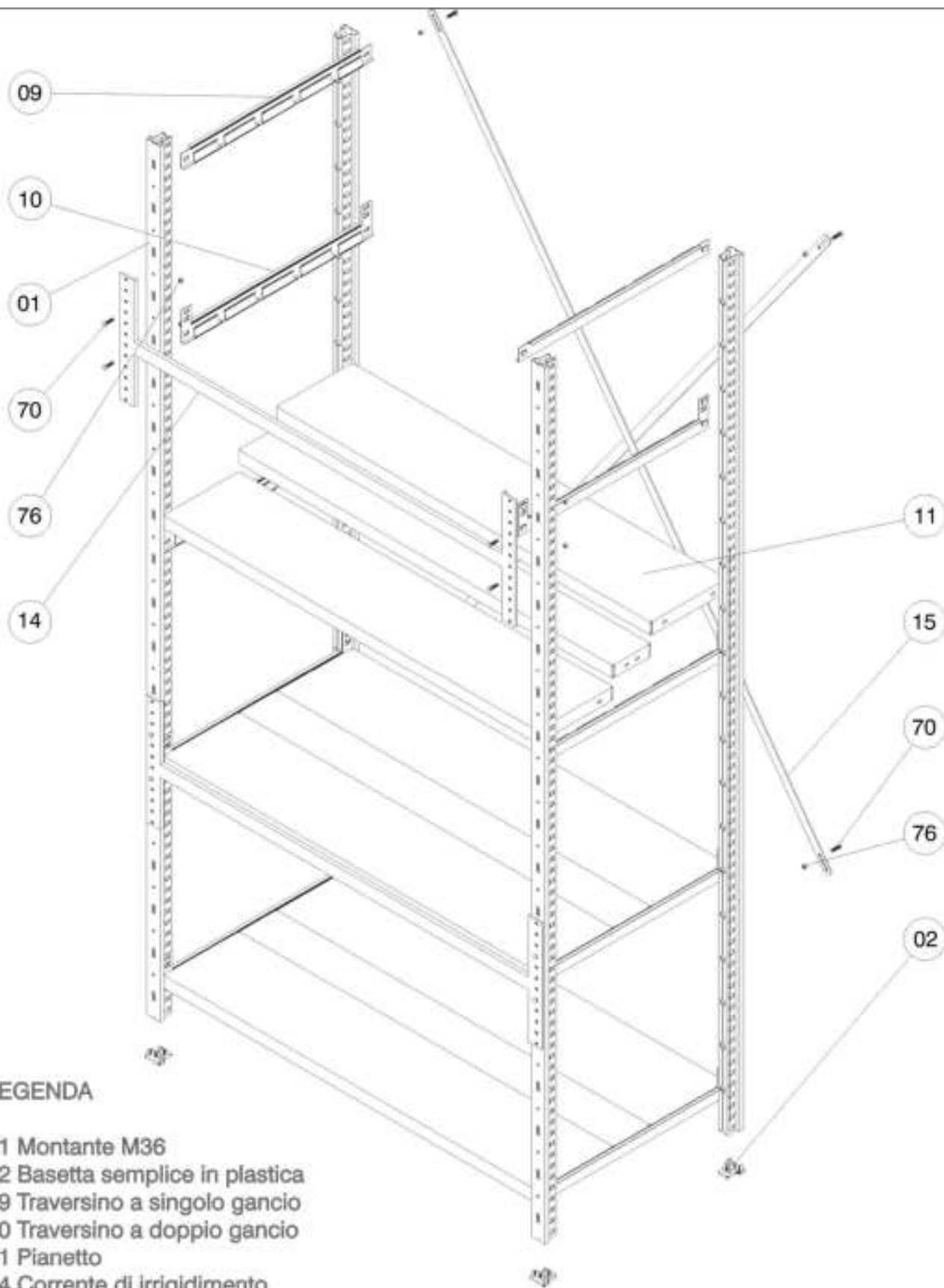

LEGENDA

- 01 Montante M36
- 02 Basetta semplice in plastica
- 09 Traversino a singolo gancio
- 10 Traversino a doppio gancio
- 11 Pianetto
- 14 Corrente di irrigidimento
- 15 Crociera
- 70 Bullone TE M5X14
- 76 Dado M5

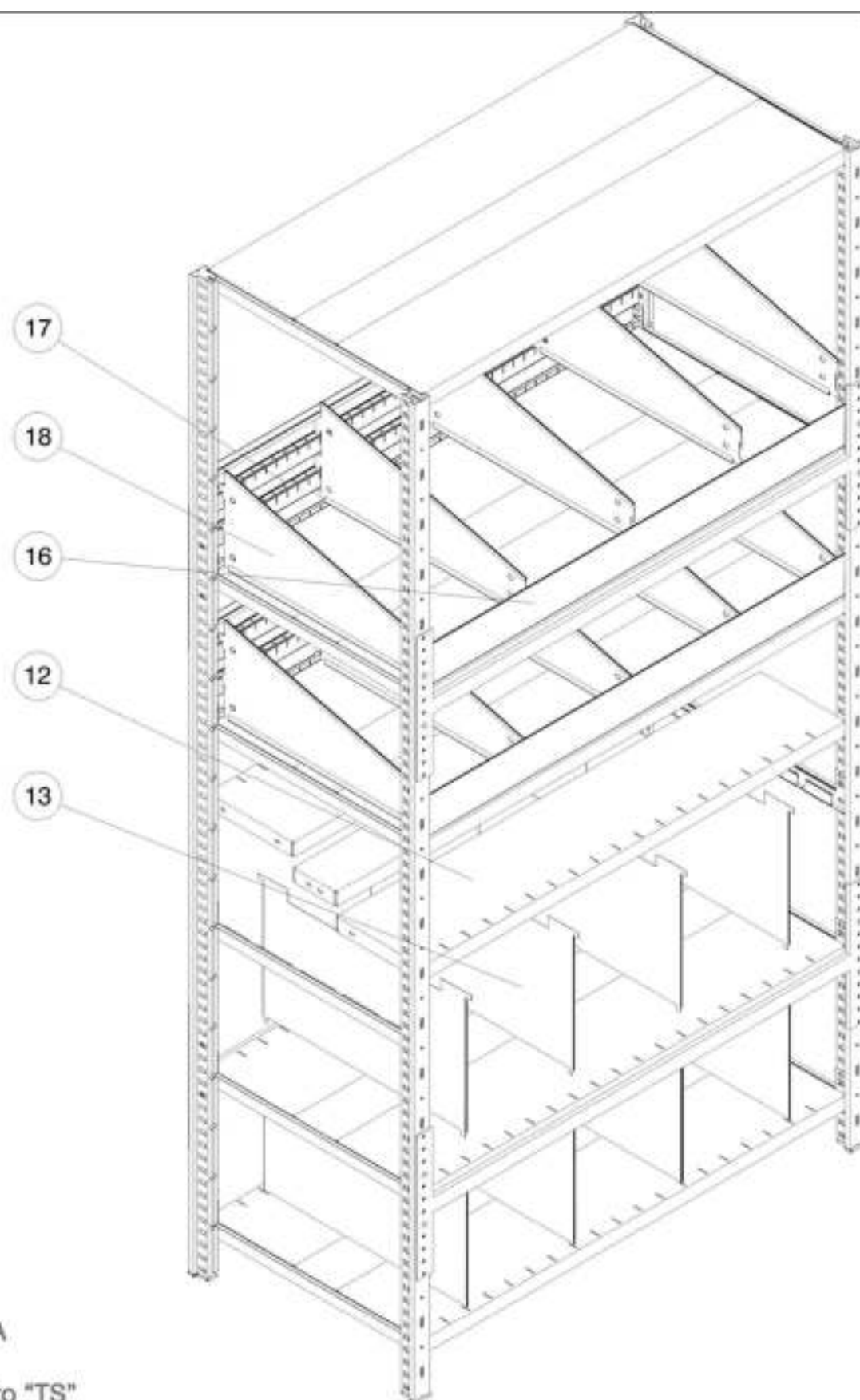

LEGENDA

- 12 Pianetto "TS"
- 13 Separatore verticale
- 16 Spondina anteriore H 80
- 17 Spondina posteriore H 200
- 18 Fianchetto separatore H 80/200

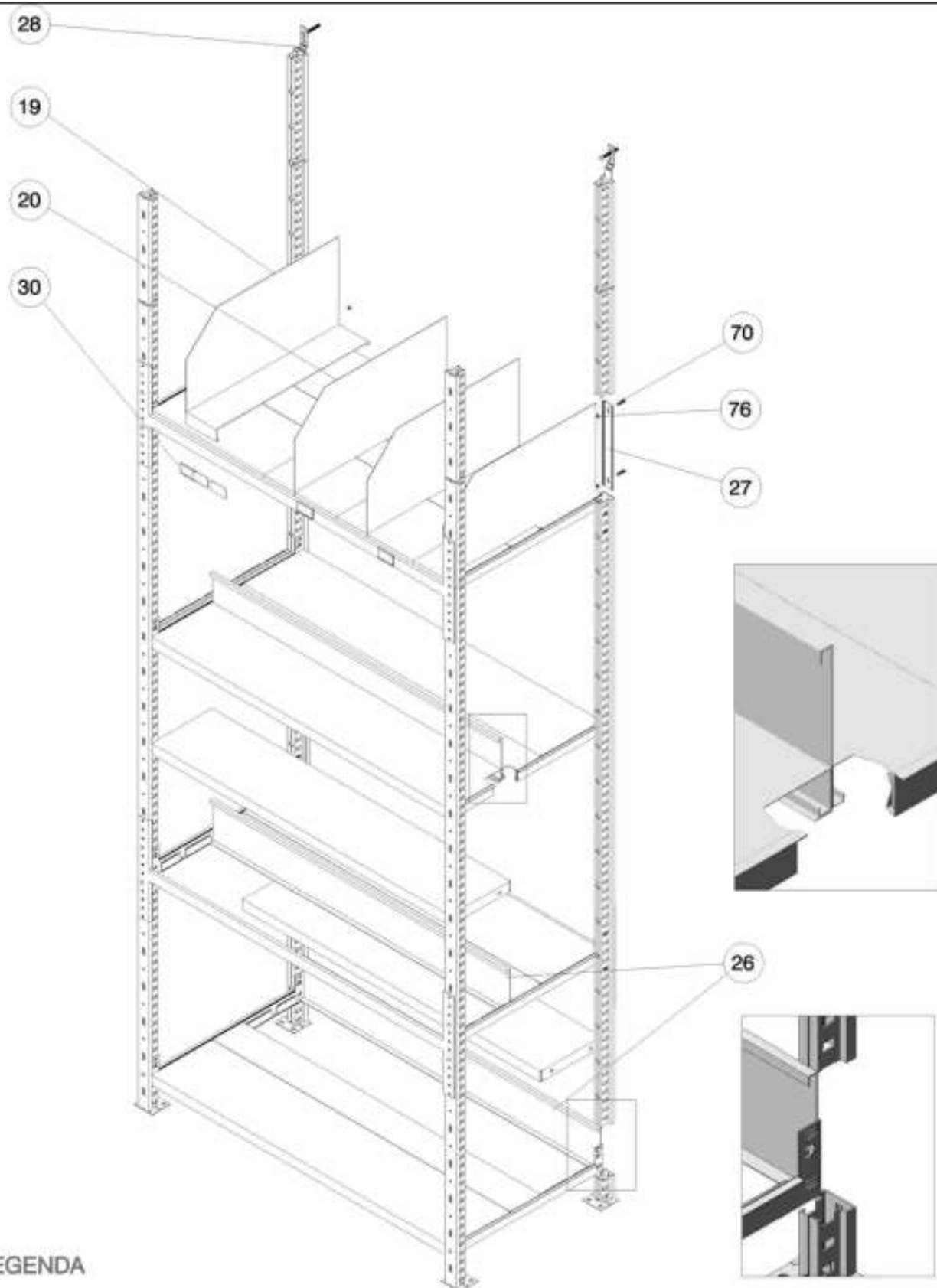

LEGENDA

- 19 Separatore mobile DX H 200
- 20 Separatore mobile SX H 200
- 26 Fascia di appoggio di fondo e centrale H 120
- 27 Giunto di prolungamento

- 28 Squadretta di fissaggio a muro
- 30 Cartellino magnetico
- 70 Bullone TE M5X14
- 76 Dado M5

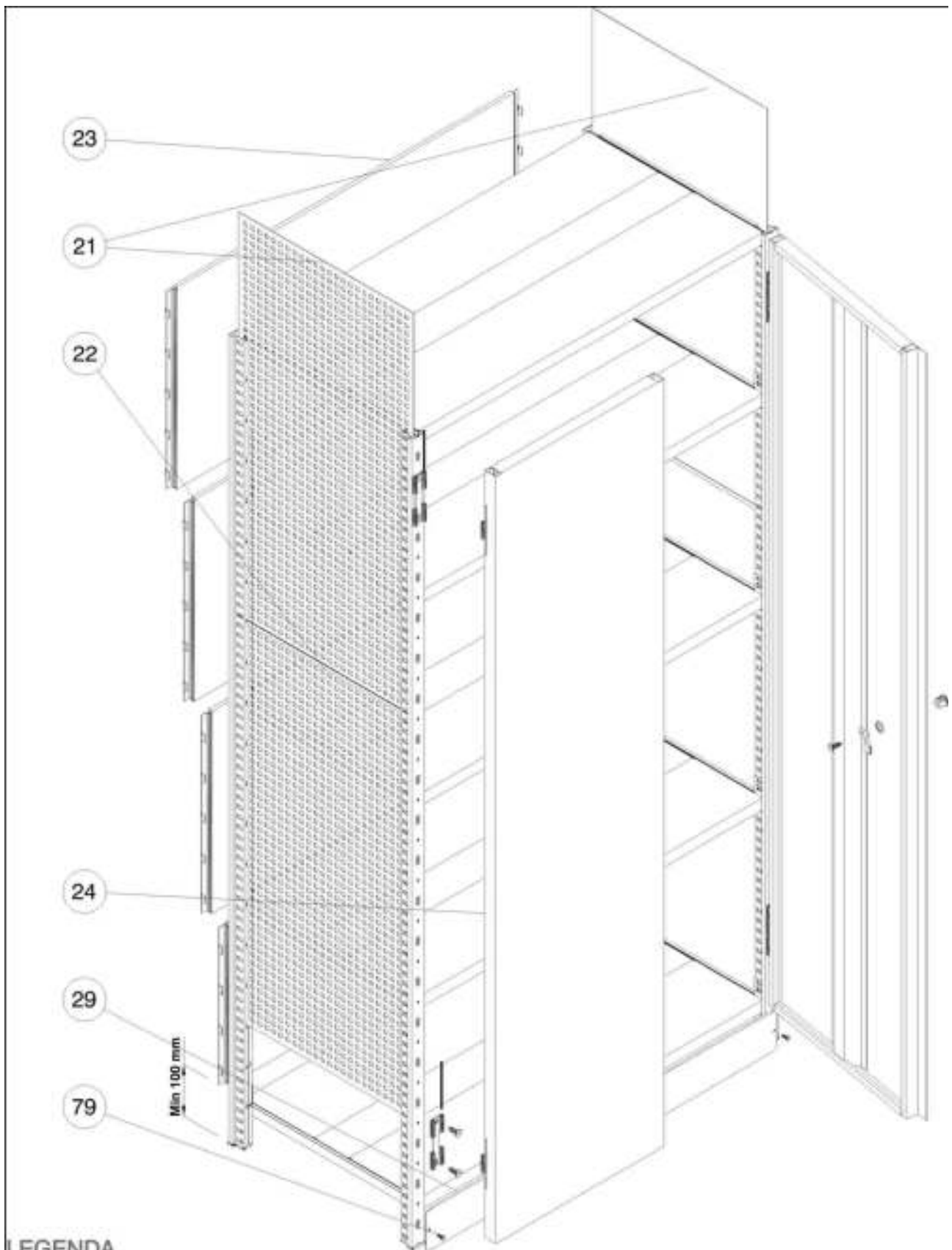

LEGENDA

21 Parete di lato - Parete di lato forata
 22 Coprigiunto in plastica
 23 Parete di fondo

24 Coppia ante a battente
 29 Zoccolo parapolvere H 100
 79 Vite auto perforante TE 6,3X19

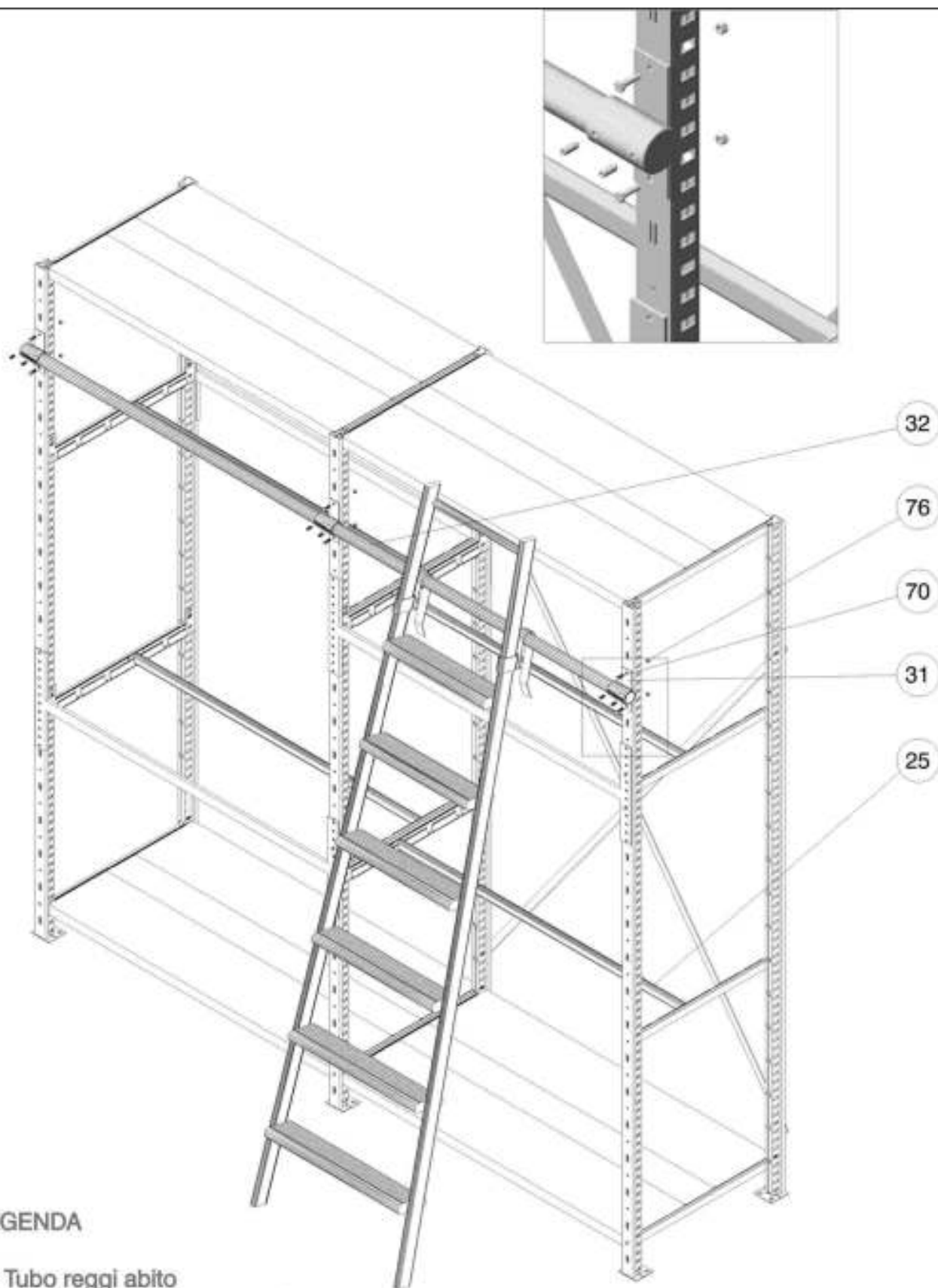

LEGENDA

- 25 Tubo reggi abito
- 31 Attacco reggi tubo per scala
- 32 Tubo reggi scala
- 70 Bullone TE M5X14
- 76 Dado M5

LEGENDA

04 Basetta in acciaio

70 Bullone TE M8X30

76 Dado M8 flangiato

80 Tassello espansione M6X60

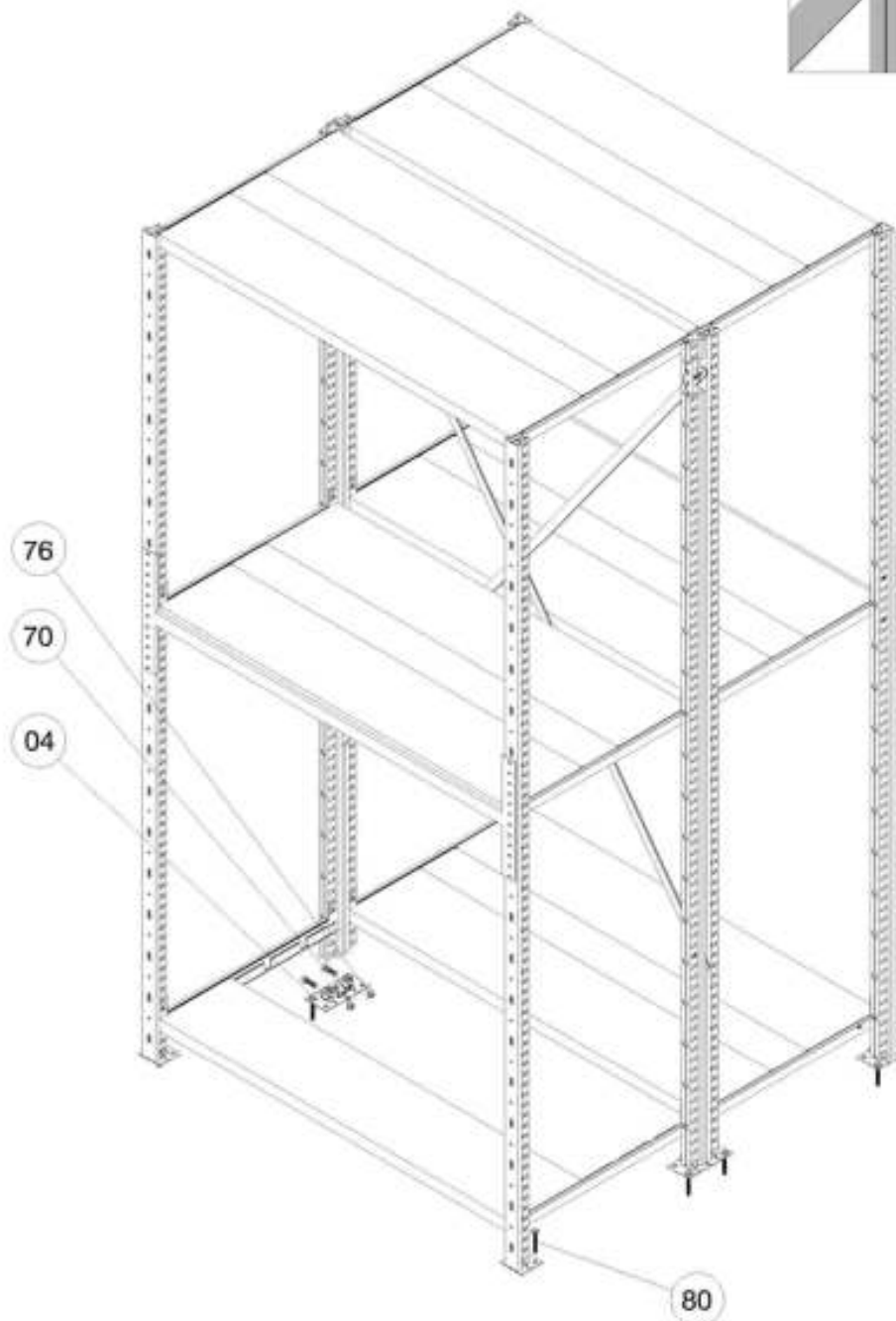
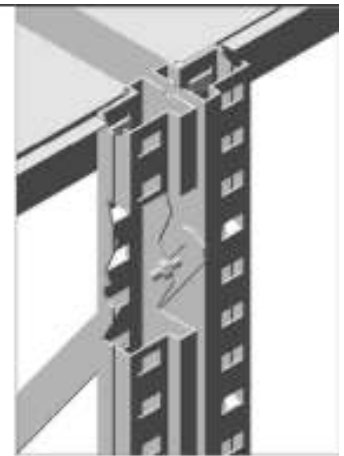

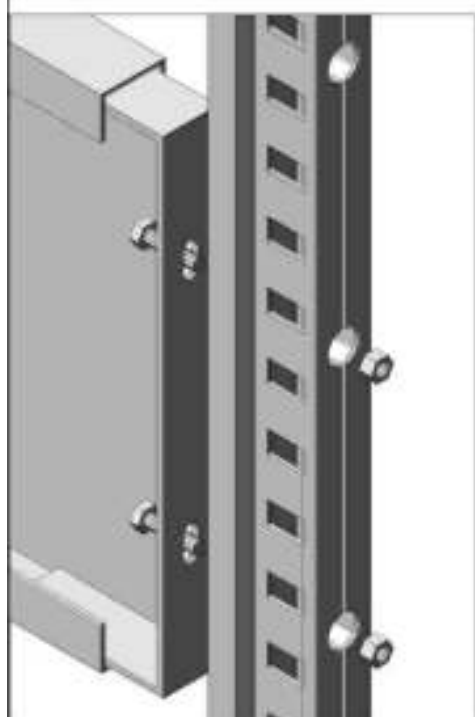
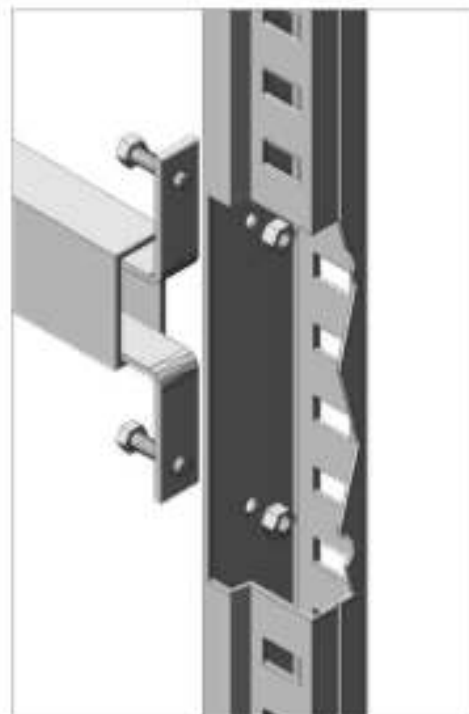
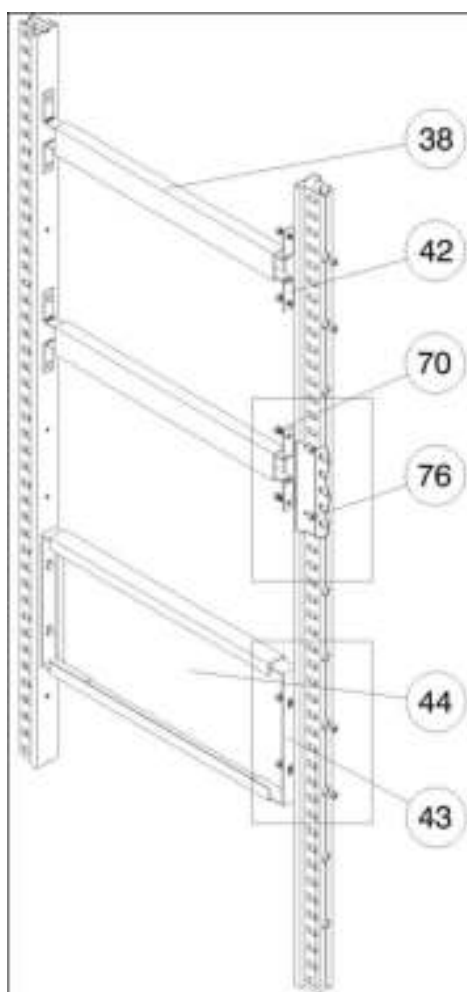

LEGENDA

- 38 Tubo corrimano
- 42 Attacco corrimano intermedio
- 43 Innesto per lamiera battipiede
- 44 Lamiera battipiede
- 70 Bullone TE M5X14
- 76 Dado M5

LEGENDA

- 38 Tubo corrimano
- 39 Giunto per tubo corrimano
- 40 Piastrina per fissaggio corrimano
- 41 Innesto ad angolo
- 42 Attacco corrimano intermedio
- 43 Innesto per lamiera battipiede
- 44 Lamiera battipiede
- 71 Bullone TE M5X40
- 72 Bullone TE M5X50
- 73 Bullone TE M5X90
- 76 Dado M5
- 78 Rondella 5X15

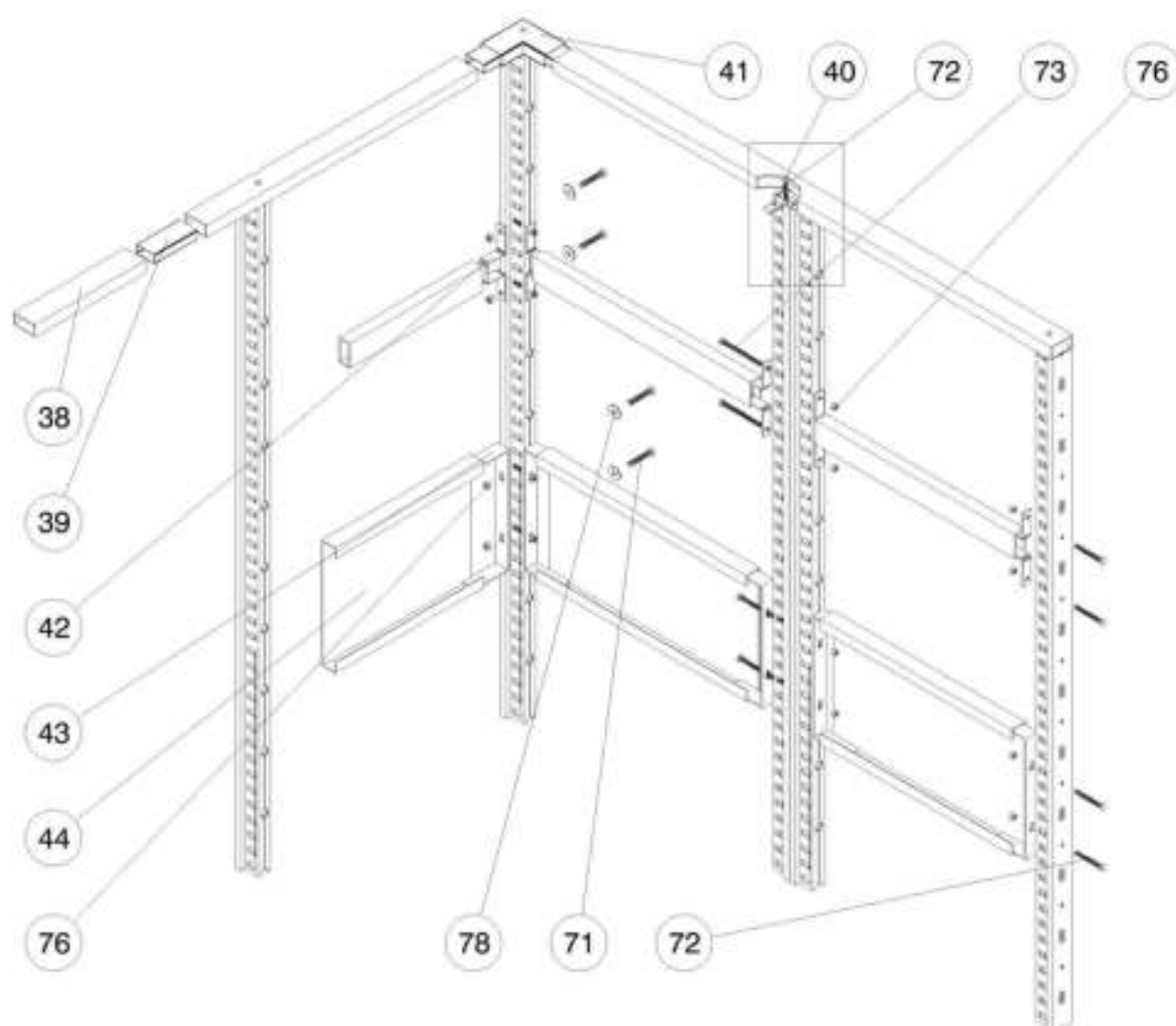

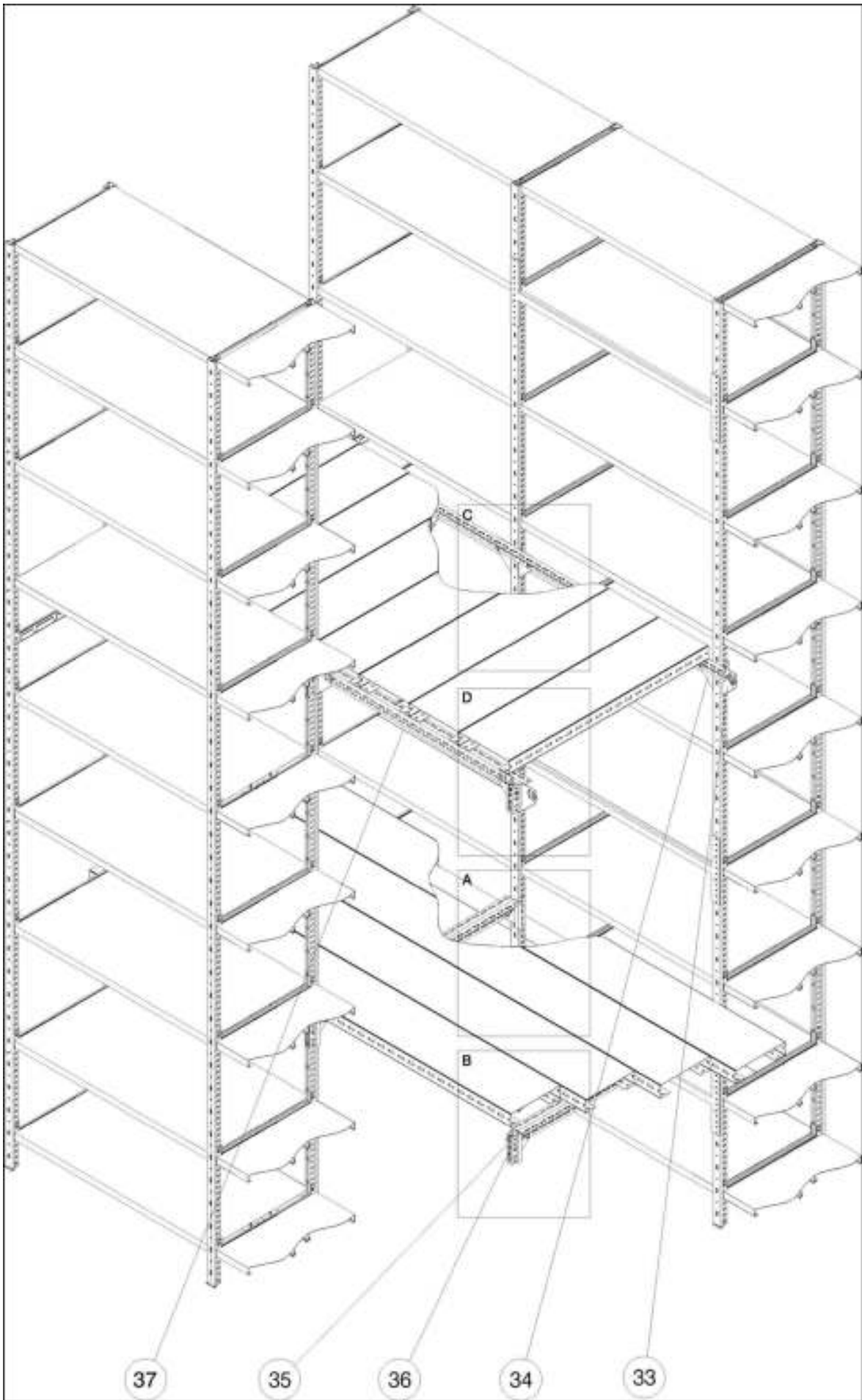

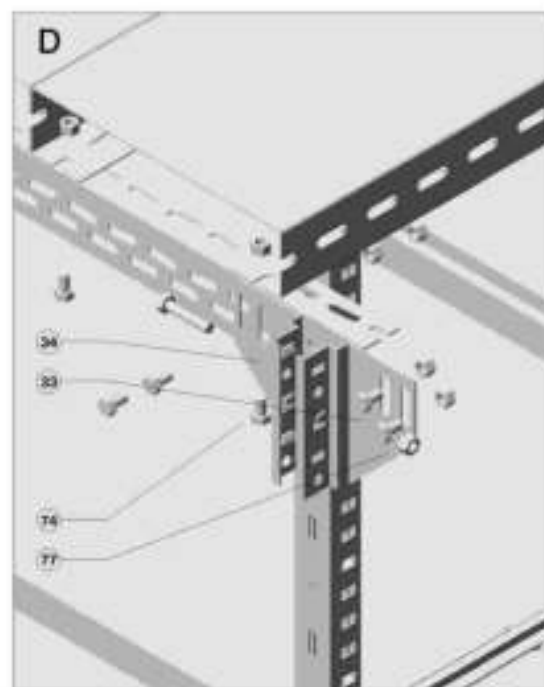
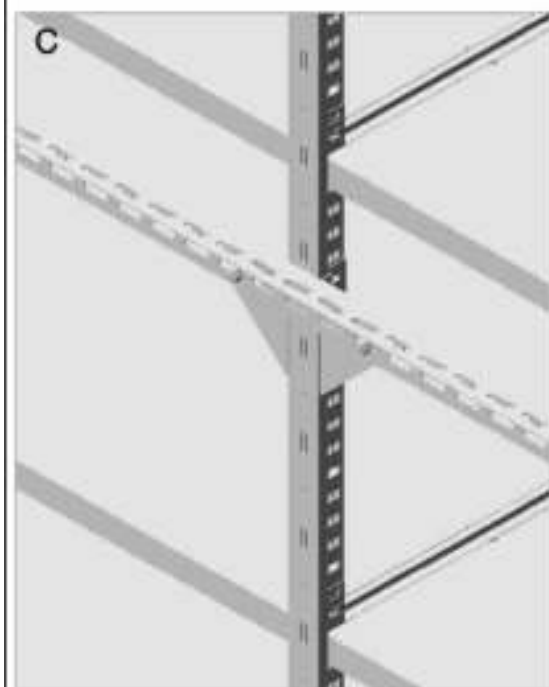
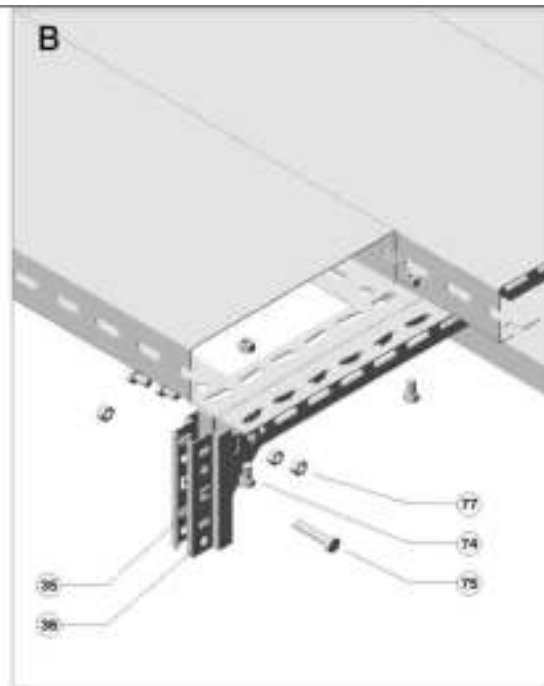
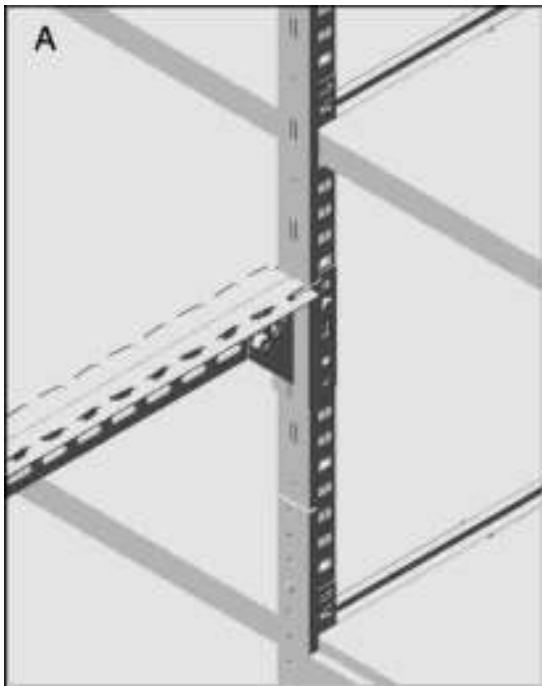

LEGENDA

33 Attacco tipo "A" DX
 34 Attacco tipo "A" SX
 35 Attacco tipo "B" DX
 36 Attacco tipo "B" SX

37 Angolare
 74 Bullone TE M8X14
 75 Bullone TE M8X40
 77 Dado M8